

MAYOR'S MEMO

News of Interest to Southfield Residents from Mayor Ken Siver

Aquatic Center moving forward as City Council reviews plans

Replacement of the swimming pool at the municipal campus is moving forward as funds are in the city budget and plans have been drawn by the architectural firm of Hobbs + Black. Recently, City Council and the administration reviewed the schematics.

The city's swimming pool, dating back to the early 1970s, failed three years ago and was beyond repair. Prior to that many repairs had been made. Parts for the original pool were no longer available and pool technology has changed drastically.

Southfield will now have an Aquatic Center, estimated to cost \$22.5 million with many additional features that residents said they would like. The new Aquatic Center will be an enclosed, year-round facility, built as an addition to the current ice arena.

Features will include a four-lane lap pool and a recreational pool with a lazy river, water slide, and therapy area. In addition, the aquatic center will include new lockers rooms and lavatories, private changing rooms, and a multipurpose room.

See page 5 for Exterior View of Aquatic Center

(NOTE: Renderings shown in this publication are preliminary and may be subject to slight modifications.)

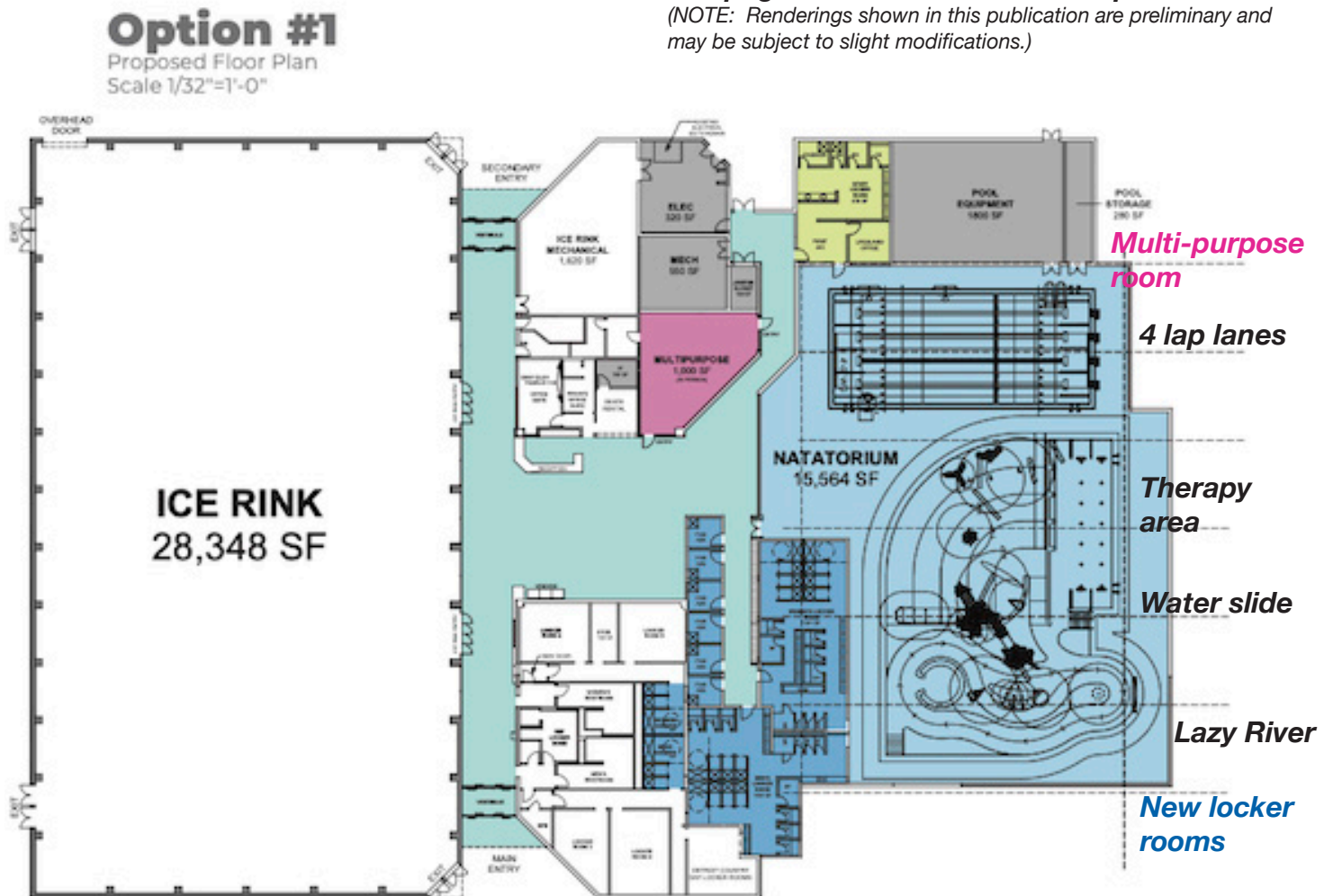

Proposal for property tax increase of 1.5 mils on Aug. 4th ballot

Oakland Intermediate School District seeks school enrichment millage

The Oakland County Intermediate School District will be placing a 1.5 school enrichment millage on the August 4, 2026 Primary Election ballot.

Should the Oakland County School Enrichment Millage gain approval, the Southfield City Assessor estimates that Southfield taxpayers will contribute \$5,000,020 to the fund in the first year. The Oakland Intermediate School District estimates that in total the enrichment millage will generate \$125,000,000 in the first year. These funds would then be distributed to the 28 county school districts and 22 charter schools based on enrollment (or a \$728 per pupil allocation). The duration of the millage if approved is six years.

Thus, over the course of six years Southfield tax-payers would be contributing over \$30 million in tax dollars while Southfield Public Schools would receive approximately \$18.7 million. However, if Southfield enrollment declines, the city's contribution remains (and possibly increases with increased property values) and the district receives less.

With voter approval of the tax increase, Southfield taxpayers will be subsidizing students in other school districts because Southfield Public Schools has lower enrollment than the majority of districts in the county. Based on Southfield Public Schools current enrollment (fall 2025), the distribution from the county enrichment millage would be \$3,115,112 in the first year. The remaining \$1,884,908 of Southfield taxes would be shared with other Oakland County districts.

Oakland County School Districts with higher enrollments to benefit the most. Southfield taxpayers will pay more while Southfield Public Schools with lower enrollment will receive a lesser share of funds generated. Thus, Southfield taxpayers will subsidize wealthier communities.

SCHOOL DISTRICT	STUDENT ENROLLMENT	DISTRIBUTION of 1.5 mill increase	CURRENT PER PUPIL Allocation/Spending	HOUSEHOLD Median Income
Charter Schools (all)	15,377	\$11,194,456	\$ 9,608	--
Rochester	14,679	\$10,686,312	\$15,568	\$120,694
Troy	12,043	\$ 8,767,304	\$15,813	\$120,823
Walled Lake	11,718	\$ 8,530,704	\$15,804	\$113,148
Clarkston	8,969	\$ 6,529,432	\$15,267	\$ 94,211
Farmington	8,963	\$ 6,525,064	\$19,361	\$104,836
South Lyon	8,194	\$ 5,965,232	\$14,768	\$ 92,467
Oxford	7,553	\$ 5,498,584	\$14,489	\$111,239
Huron Valley	7,371	\$ 5,366,088	\$15,578	\$105,941
Birmingham	7,245	\$ 5,274,360	\$20,452	\$156,104
Lake Orion	6,835	\$ 4,975,880	\$15,186	\$101,318
Novi	6,753	\$ 4,916,184	\$15,660	\$113,967
Southfield	4,279	\$ 3,115,112	\$21,892	\$ 68,166
Pontiac	3,702	\$ 2,695,056	\$32,261	\$ 44,329
Oak Park	2,948	\$ 2,146,144	\$19,692	\$ 71,510
Hazel Park	2,842	\$ 2,068,976	\$19,461	\$ 67,073
Clawson	1,227	\$ 893,256	\$17,338	\$ 88,638

School districts with higher enrollments will benefit most from this additional millage. These districts are more affluent and, generally speaking, have a greater ability to assume the cost of the tax increase. Approval of the proposed increase will be by a county-wide vote.

If approved, the tax increase for the enrichment millage for homeowners will vary from approximately \$150 on a home valued at \$200,000 to \$600 for higher-valued homes.

Data supplied by the Oakland Intermediate School District and the City of Southfield's Assessor's Office.

Mayor, City Council reaffirm Southfield as Welcoming City

In light of events that have unfolded nationally over the past year, including deportation of bona fide American citizens and numerous antisemitic attacks, the Southfield Mayor and City Council reaffirmed Southfield as a Welcoming City for immigrants, refugees, and all people.

people from Central America, Mexico, and the Middle East, Southfield elected officials moved to re-state and reaffirm that Southfield is a Welcoming City ... a city that embraces and celebrates diversity and appreciates cultural differences ... a city that will not tolerate acts of hate towards any group of people.

Originally, adopted in April 2017, during a period of heightened intolerance and hate speech towards

The resolution below was re-adopted by the City Council at its meeting of March 23, 2026.

JOINT RESOLUTION

Southfield: Welcoming City for Immigrants, Refugees, All People

Whereas, the City of Southfield believes in the innate dignity of all people, and acknowledges, honors, and values our immigrant and migrant roots, and embraces the values of family, faith, and hard work; and

Whereas, the City of Southfield celebrates diversity and recognizes that invaluable contributions to our social, religious, cultural, and economic landscape have come from a wide variety of racial and ethnic backgrounds; and

Whereas, the City of Southfield, and the southeastern Michigan region as a whole, has long been home to immigrants from around the world, who come seeking opportunity, stability, prosperity, and a better life for their families; and

Whereas, the City of Southfield has long been recognized as a hospitable and welcoming place, where people, families, and institutions thrive and the contributions of all are celebrated and valued, and is committed to being a diverse, inclusive, and global city, as evidenced by our publicly supported human rights ordinance, and

Whereas, recent events on the national stage demand that people and communities of conscience speak out in defense of, and reaffirm their commitment to, this most basic American value; and

Whereas, the City of Southfield will continue to provide a neighborly and welcoming atmosphere, where all are respected and accepted, and the Welcoming City of Southfield initiative aims to build cooperation, respect, and compassion among all in our city, including immigrants and non-immigrants alike; endeavors to create an atmosphere in which immigrants and refugees have increased opportunities to integrate into the social fabric of their adopted hometowns; and seeks to embrace diversity while supporting and retaining unique cultural identities; and

NOW, THEREFORE, BE IT RESOLVED, by the Mayor and City Council of the City of Southfield, on March 23, 2026, that the City of Southfield is affirmed as a place where all foreign-born and native-born Americans can live, work, and play together, share in each other's customs and ideals, and appreciate and promote cultural diversity.

Dated this 23rd day of March, 2026.

Kenson J. Siver, *Mayor*
Coretta Houge, *Council President Pro Tem*
Ashanti Bland, *Councilwoman*
Yolanda C. Haynes, *Councilwoman*

Charles Hicks, *Council President*
Nancy L.M. Banks, *Councilwoman*
Daniel Brightwell, *Councilman*
Michael A. Mandelbaum, *Councilman*

Fire Department takes delivery of new aerial truck

Three years in the making, the Southfield Fire Department took possession of a new aerial tower fire truck this winter. This latest piece of firefighting equipment was approved for purchase three years ago by City Council.

The cost of this truck was \$1.8 million. It comes with a 100-foot ladder with a bucket platform to reach multistory buildings. Other features include 183 feet of ground ladders, a pinless jack stabilization system, 2,000-gallon-per-minute water pump, two remote control nozzles that can be operated from the ground, a remote video system that enables firefighters to view elevated fire scenes, and 500 feet of hose.

Aerial fire or hook and ladder trucks are only manufactured by a few companies. Lead time from order to delivery is great. Southfield's new aerial truck was manufactured by Sutphen Corporation, a family-owned company that has been building custom fire trucks since 1890. Sutphen is well-known for its Mid-Mount Aerial Platforms and heavy-duty ladders.

Public unveiling of the new truck was held in March.



Congresswoman Rashida Tlaib presents a check for \$3.15 million to Southfield officials for the Aging in Place Critical Home Repair Program. The check was presented at the Oakland County Habitat for Humanity Re-Store on Telegraph Road in Southfield. The city will administer the program with Habitat for Humanity performing the repairs. Mayor Ken Siver initiated the partnership with Habitat over a decade ago. The result has been new and rehabbed housing.

Congresswoman Tlaib secures funding for home repairs for income eligible seniors

Southfield has long-placed an emphasis on aging in place for its senior residents. Due to limited income and physical limitations, it is challenging for some seniors to maintain their single family home.

At the city's request, Congresswoman Rashida Tlaib worked to secure funding for home repairs for income eligible senior homeowners. The congresswoman was successful in securing the funds.

The repair program is expected to begin in fall 2026 with work performed by Habitat for Humanity Oakland County.

Continued from Page 1



Exterior rendering of new aquatic center to adjoin the existing ice arena on the municipal complex.



New public art acquisition

Sun Outdoors Company, headquartered in Southfield, has donated the *Paper Airplanes* art installation to the city. It has been installed at the corner of Evergreen Road and the I-696 Service Drive.

MAYOR'S MEMO

The Mayor's Memo is an occasional newsletter produced by Mayor Ken Siver and not done at city expense. The Memo provides city news & updates to residents. To subscribe, send an email to bastrop@cityof-southfield.com Feel free to pass this newsletter on to others.

City public art keeps advancing

A new exhibit by 11 local artists is now gracing the City Hall lobby until June 30. An artists' reception to be held at 6pm in the lobby on April 16. Free admission and open to all.

ATTITUDES & IMAGES

ARTIST OPENING RECEPTION
Thursday April 16,
6:00 PM - 8:00 PM

PRESENTED BY
 SOUTHFIELD MI
 PUBLIC ARTS COMMISSION

Terrell Anglin
 Arlinda Crossland
 Daphne Means Curtis
 Paul Curtis
 Lynn Galbreath
 Kim Adams House
 Terrie Hylton
 Amanda Koss
 Debbie Lim
 Alessandra Collar Lipman
 Steven Mealy

EXHIBITION ON DISPLAY APRIL 16 - JUNE 30, 2026

SOUTHFIELD CITY HALL-MAIN LOBBY
 26000 EVERGREEN RD., SOUTHFIELD, MI 48076
 FOR MORE INFORMATION: 248.796.5100

Southfield
 the center of it all™