

CITY OF SOUTHFIELD

OAKLAND COUNTY, MICHIGAN

PLAN OF PROPOSED 2019 INFRASTRUCTURE PROGRAM SECTION 24 AREA 4

WATER MAINS, SANITARY SEWER AND ROAD REPLACEMENT

CITY OF SOUTHFIELD PROJECT NUMBER: 1712SFLD

CITY OF SOUTHFIELD

KENSON J. SIVER
Mayor

LLOYD CREWS
Council President

LINNIE TAYLOR
DANIEL BRIGHTWELL
DONALD F. FRACASSI
MYRON FRASIER
MICHAEL MANDELBAUM
TAWNIA MORRIS

City Council Members

SHERIKIA L. HAWKINS
City Clerk

IRV M. LOWENBERG
City Treasurer

FREDERICK E. ZORN
City Administrator

LEIGH SCHULTZ, P.E.
City Engineer

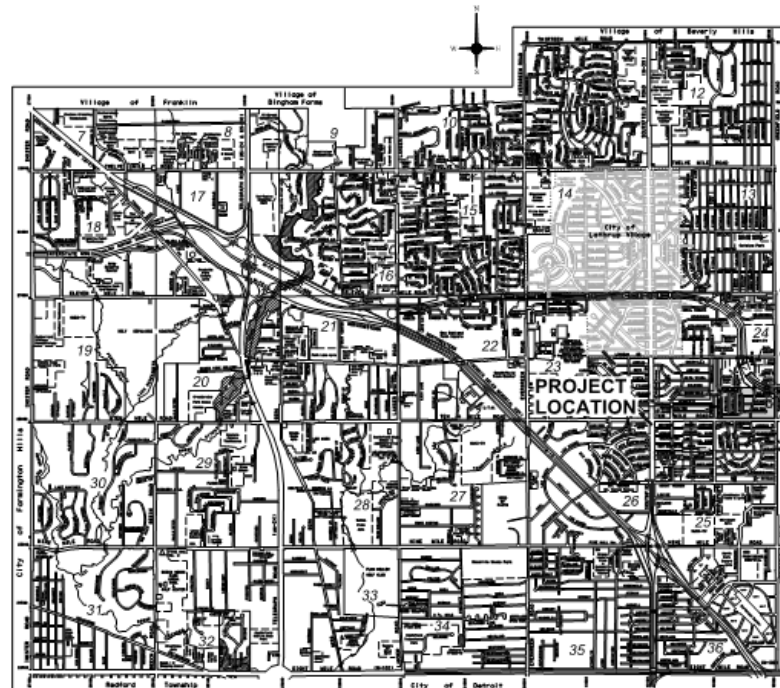

INDEX OF SHEETS

SHEET No.	DESCRIPTION
C-1	COVER SHEET
C-2	GENERAL NOTES AND LEGEND SHEET
C-3	OVERALL PLAN
C-4	CONSTRUCTION STAGING PLAN
C-5	TYPICAL CROSS SECTIONS MAINTAINING TRAFFIC
C-5A	TYPICAL CROSS SECTIONS MAINTAINING TRAFFIC/IMA ALTERNATE
C-6	TYPICAL CROSS SECTIONS
C-6A	TYPICAL CROSS SECTIONS IMA ALTERNATE
C-7 thru C-10	TYPICAL SECTIONS AND DETAILS
C-11	SOIL EROSION AND SEDIMENTATION CONTROL PLAN
C-12 thru C-18	SOUTHWOOD DR. - CONSTRUCTION PLANS AND PROFILES
C-17	PEARSON - CONSTRUCTION PLAN AND PROFILE
C-19 thru C-23	SHERWILDE DR. - CONSTRUCTION PLANS AND PROFILES
C-24 & C-25	FRANKIE DR. - CONSTRUCTION PLANS AND PROFILES
C-26 & C-27	BRIDGE CLIFF DR. - CONSTRUCTION PLANS AND PROFILES
C-28 thru C-32	HILTON ST. - CONSTRUCTION PLANS AND PROFILES
C-33 thru C-35	KINGSWIRE RD. - CONSTRUCTION PLANS AND PROFILES
C-37 & C-38	JEANETTE ST. - CONSTRUCTION PLANS AND PROFILES
C-39 & C-40	GOLDWIN PL. - CONSTRUCTION PLANS AND PROFILES
C-41, C-42 & C-43	FARFAX ST. - CONSTRUCTION PLANS AND PROFILES
C-44	TENHILE RD. - CONSTRUCTION PLAN
C-45 thru C-48	STORM PROFILE CROSS SECTIONS
C-49 thru C-64	INTERSECTION AND SIDEWALK RAMP GRADING PLANS
C-58 & C-59	GALE-DE-INC BRIDGES PLANS
CITY OF SOUTHFIELD STANDARD DETAILS	
1:4 & 1:8 WATER MAIN DETAILS	
1:4 & 1:8 2' DIA. SANITARY SEWER DETAILS AND NOTES	
1:4-1	SEWER CLEAN NOTES AND DETAILS
1:4-1	SOIL EROSION AND SEDIMENT CONTROL DETAILS

03-14-2019 ISSUED FOR BIDS

SHEET No.
C-1



CITY OF SOUTHFIELD PROJECT NUMBER:
1712SFLD

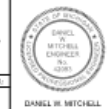

DANIEL W. MITCHELL



NATHANIEL G. SLICKER



CALL AREA 800
777 HOURS
OR WORKING HOURS
BEFORE YOU CALL
1-800-482-7171
OR 248-444-0000
(TOLL FREE)

HRC
HUBBELL, ROTH & CLARK, INC
CONSULTING ENGINEERS SINCE 1915

Project Highlights

- Roads will be completely reconstructed in concrete, with new approaches for each home.
- Water mains will be replaced throughout the project.
- Combined sewers will be separated and sanitary flow will be directed to the new pump station at 10 Mile and Pierce.
- Storm leads will be left for each home to connect sump pump lines.

Project Highlights Cont.

- Sidewalk ramps will be upgraded to meet the Americans with Disabilities Act guidelines.
- Project will be constructed in stages to reduce the impact on residents. Entire Project will take 2 years to complete.
- Mid-May construction start to October 2020
- \$13M investment funded by the Water and Sewer Capital Improvements Bond.

Construction Staging Plan

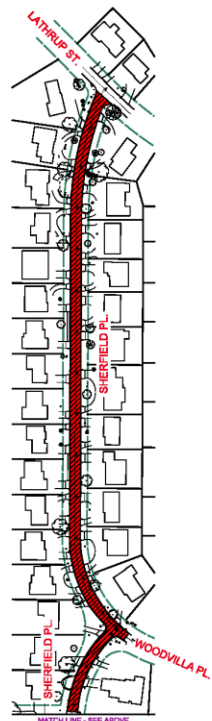
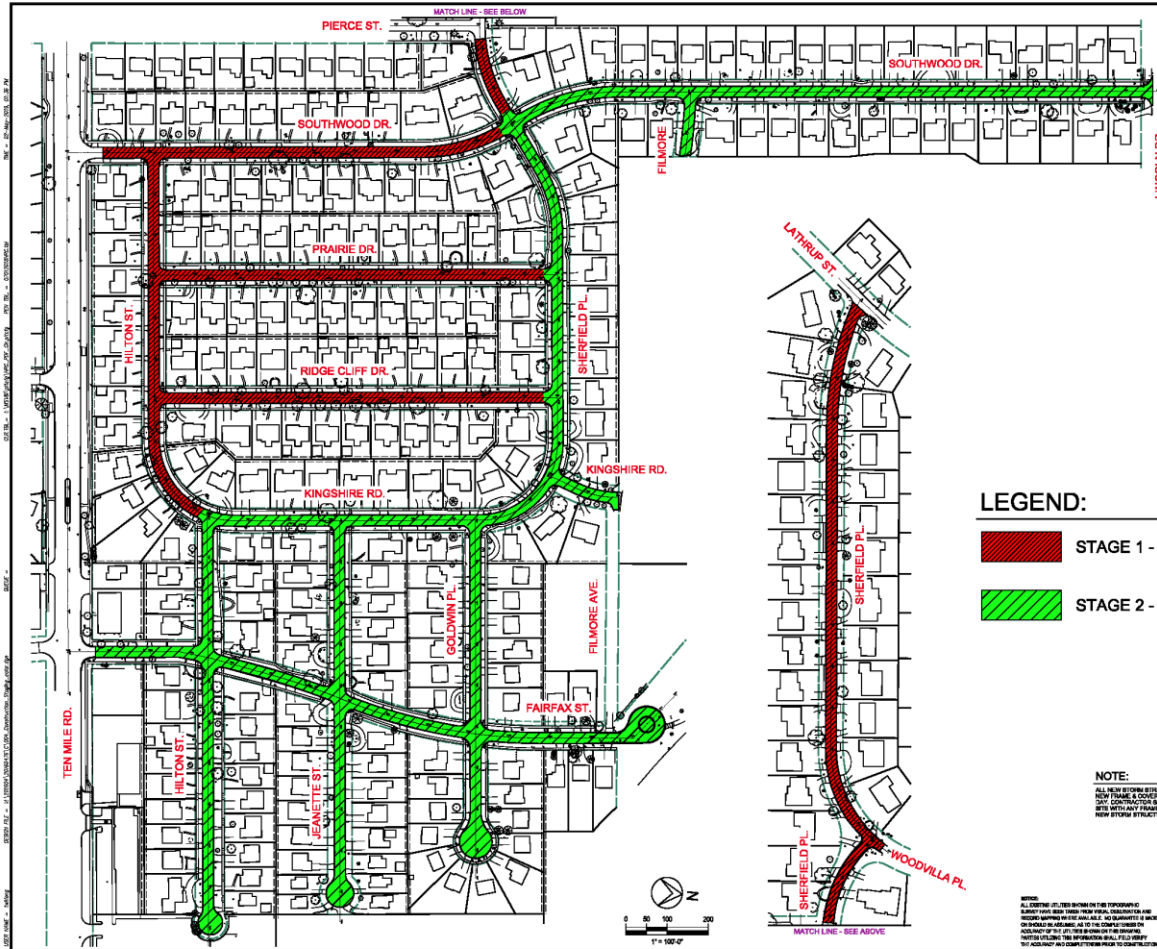

- LEGEND:**
- STAGE 1 - 2019
 - STAGE 2 - 2020

NOTE:
 ALL NEW STORM STRUCTURES SHALL HAVE NEW FINISH & COVERS INSTALLED THE SAME DAY. CONTRACTOR SHALL NOT LEAVE THE SITE WITHOUT FINISH & COVERS OFF ANY NEW STORM STRUCTURES.



HRC
 HUBBELL, ROTH & CLARK, INC.
 CONSULTING ENGINEERS SINCE 1915

180 WESTVIEW
 BLOOMFIELD HILLS, MICH. 48301-2000

PHONE: 248-844-4400
 FAX: 248-844-0800
 WWW.HRC-INC.COM

DATE	BY	REVISION

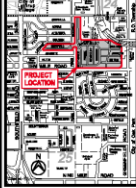

CITY OF SOUTHFIELD
SECTION 24 AREA 4
WATER MAINS,
SANITARY SEWER
AND ROAD
REPLACEMENT

CONSTRUCTION
STAGING PLAN

REC. NO. 21180478
 SHEET NO. C-4
 DATE: FEBRUARY 2018

SCALE: 1" = 100'

HRC
HUBBELL, ROTH & CLARK, INC.
CONSULTING ENGINEERS SINCE 1915

Overall Project Scope

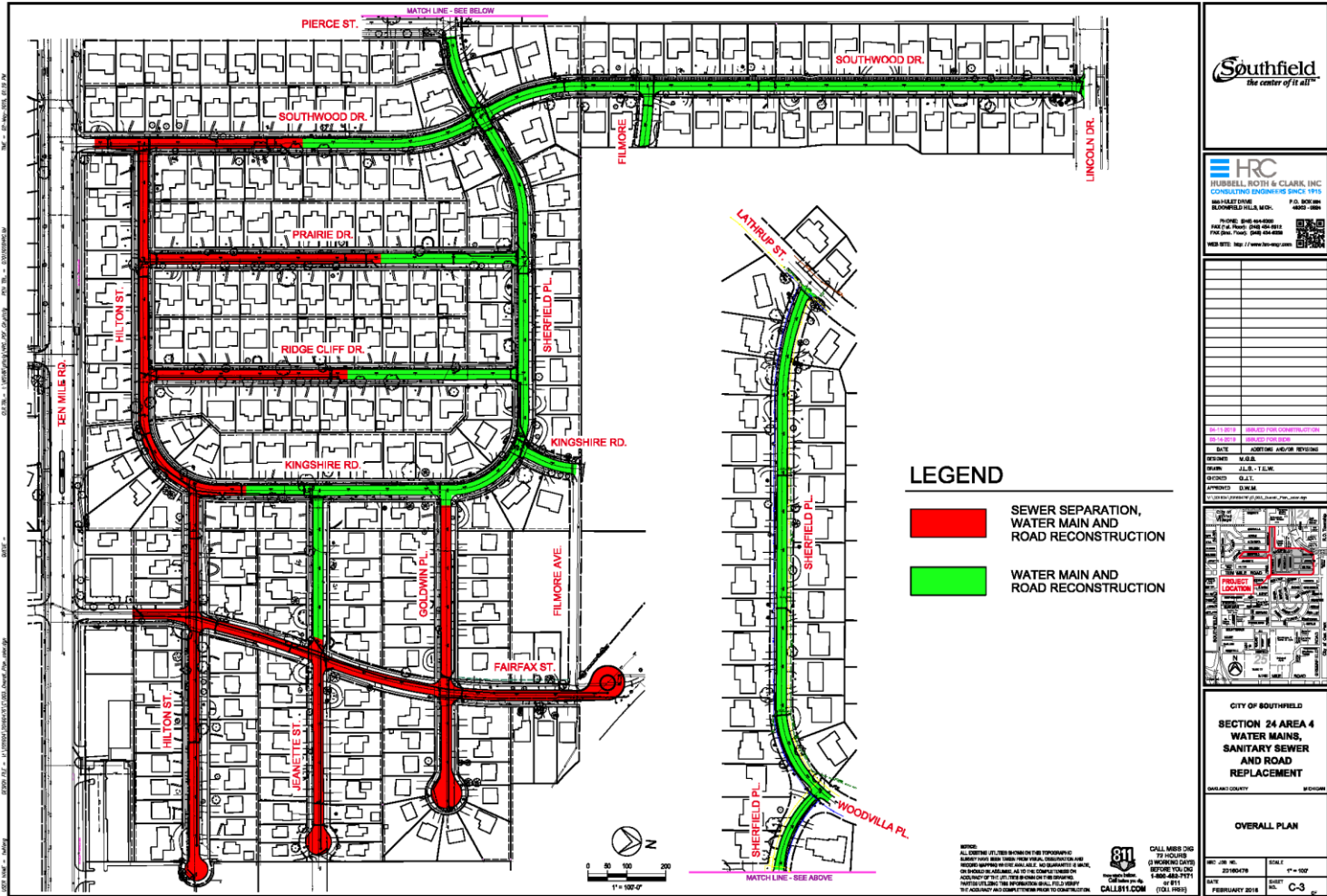

Southfield
the center of it all™

HRC
HUBBELL, ROTH & CLARK, INC.
CONSULTING ENGINEERS SINCE 1915

400 HARBORVIEW
BLOOMFIELD HILLS, MI 48301-2884
FAX: 248-858-1800

PHONE: 248-858-4000
FAX: 248-858-4000
1700 Green Road, Suite 200, Farmington Hills, MI 48334-4000
www.hrc.com

HRC
HUBBELL, ROTH & CLARK, INC.
CONSULTING ENGINEERS SINCE 1915

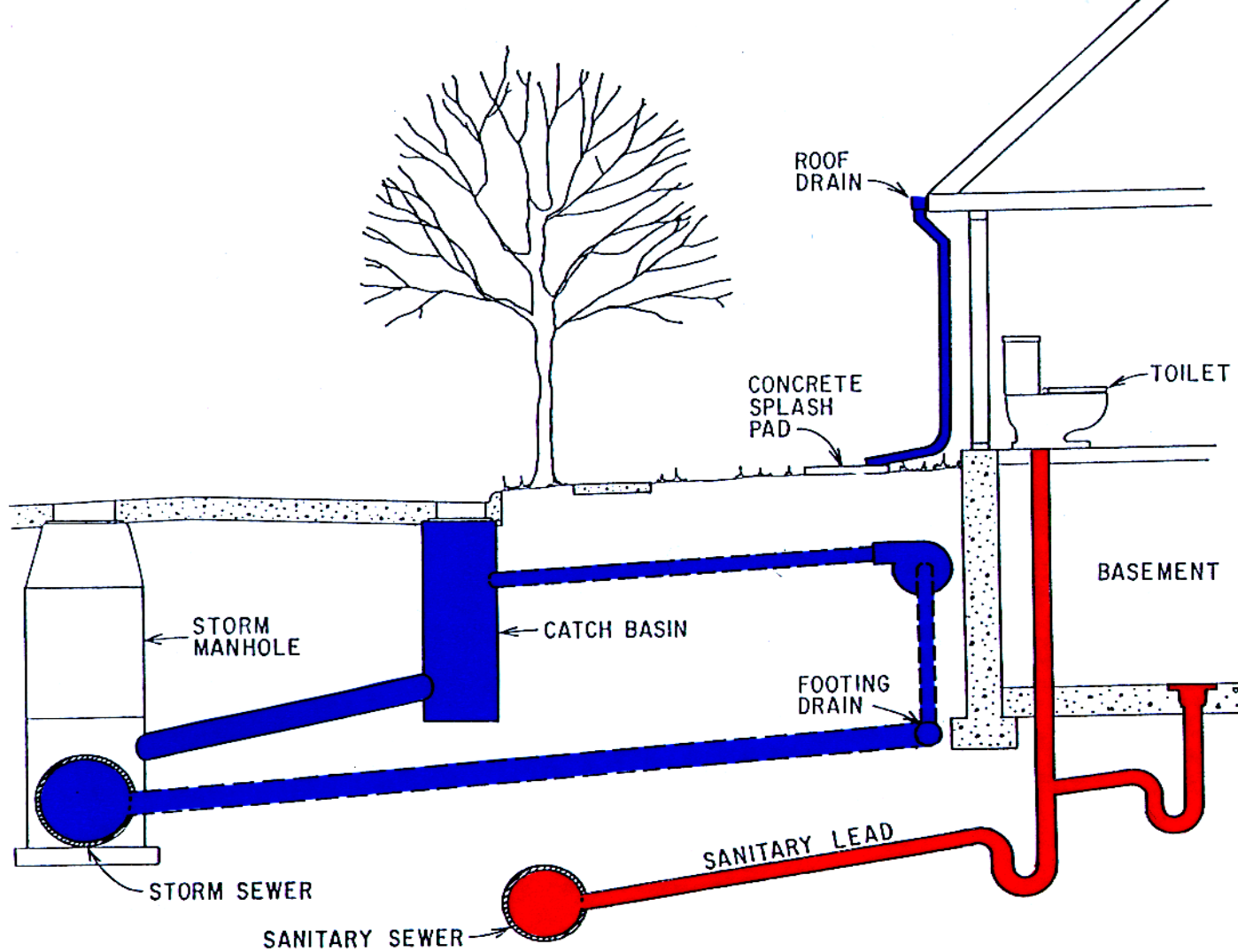

SEPARATE SEWER SYSTEM

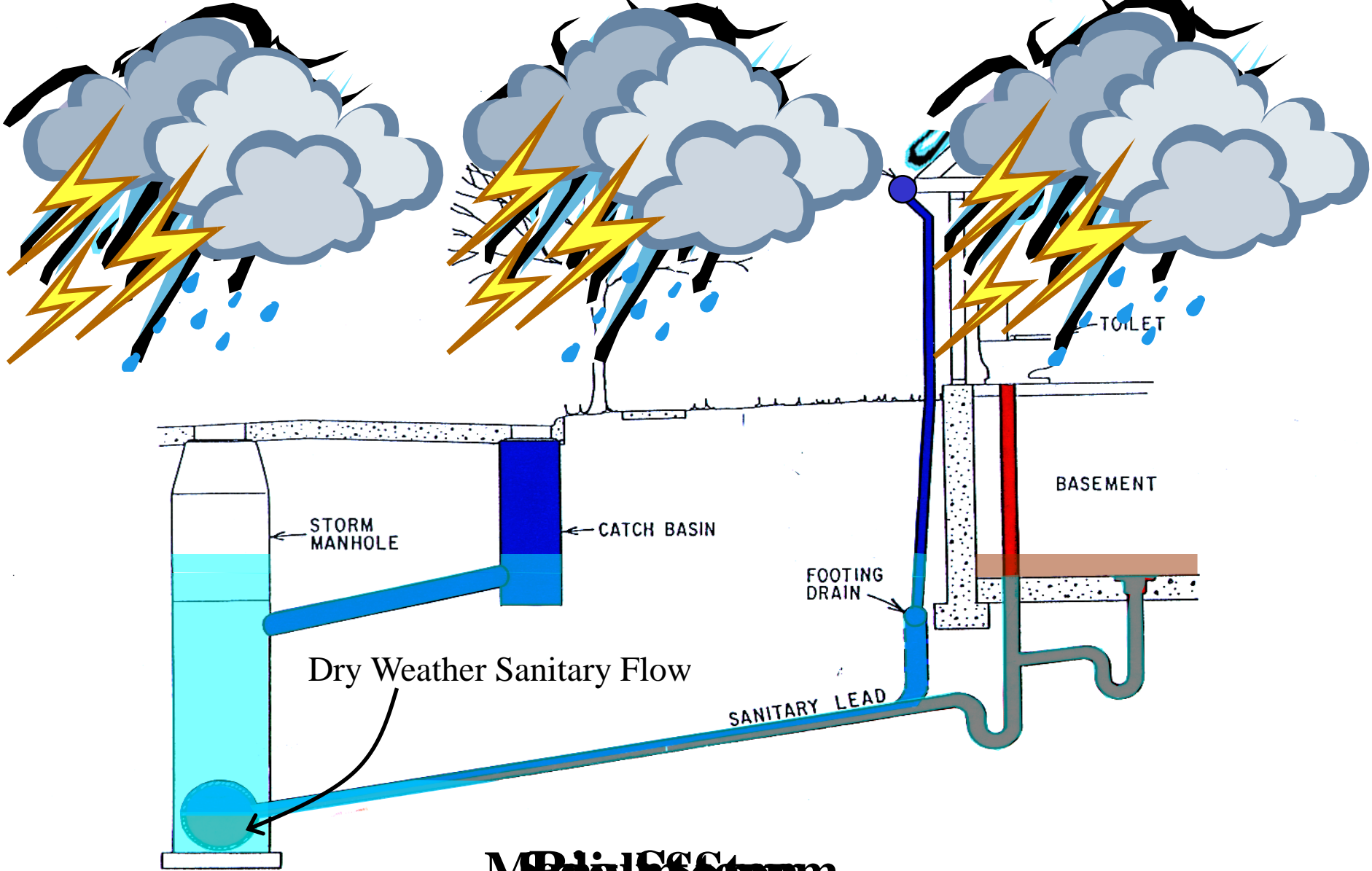

Big Storm
Combined Sewer System

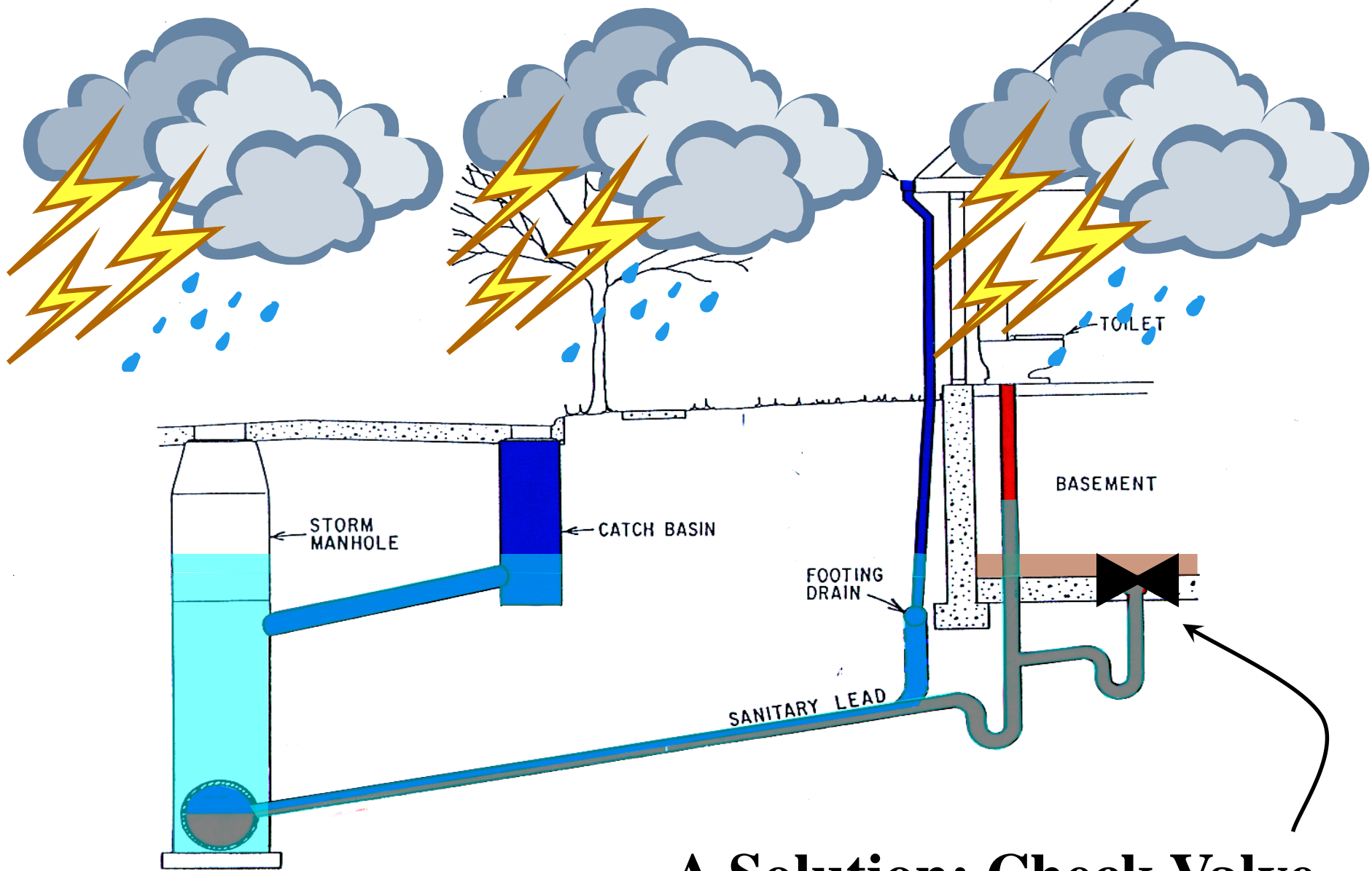

A Solution: Check Valve

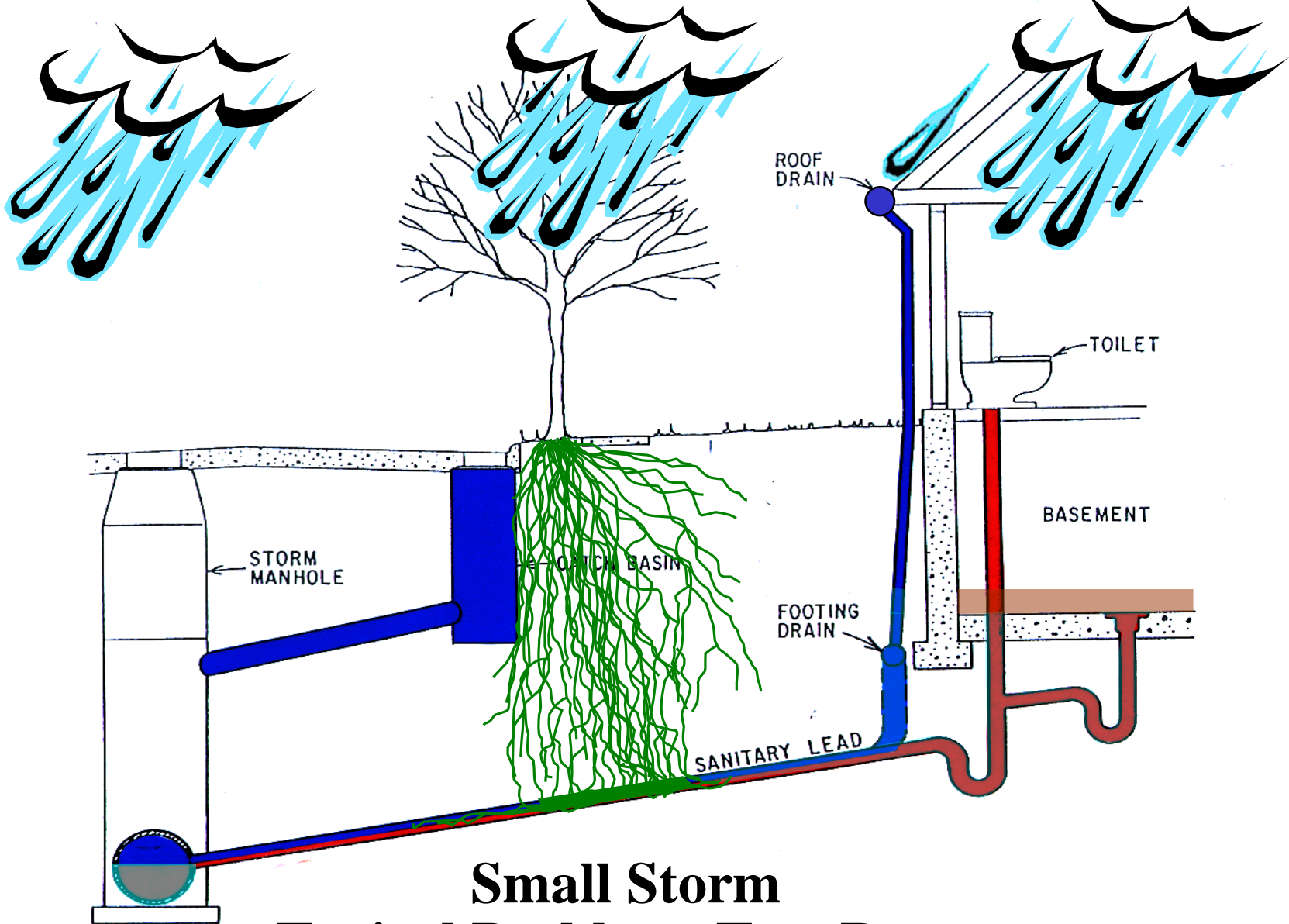

**Small Storm
Typical Problem: Tree Roots
Combined Sewer System**

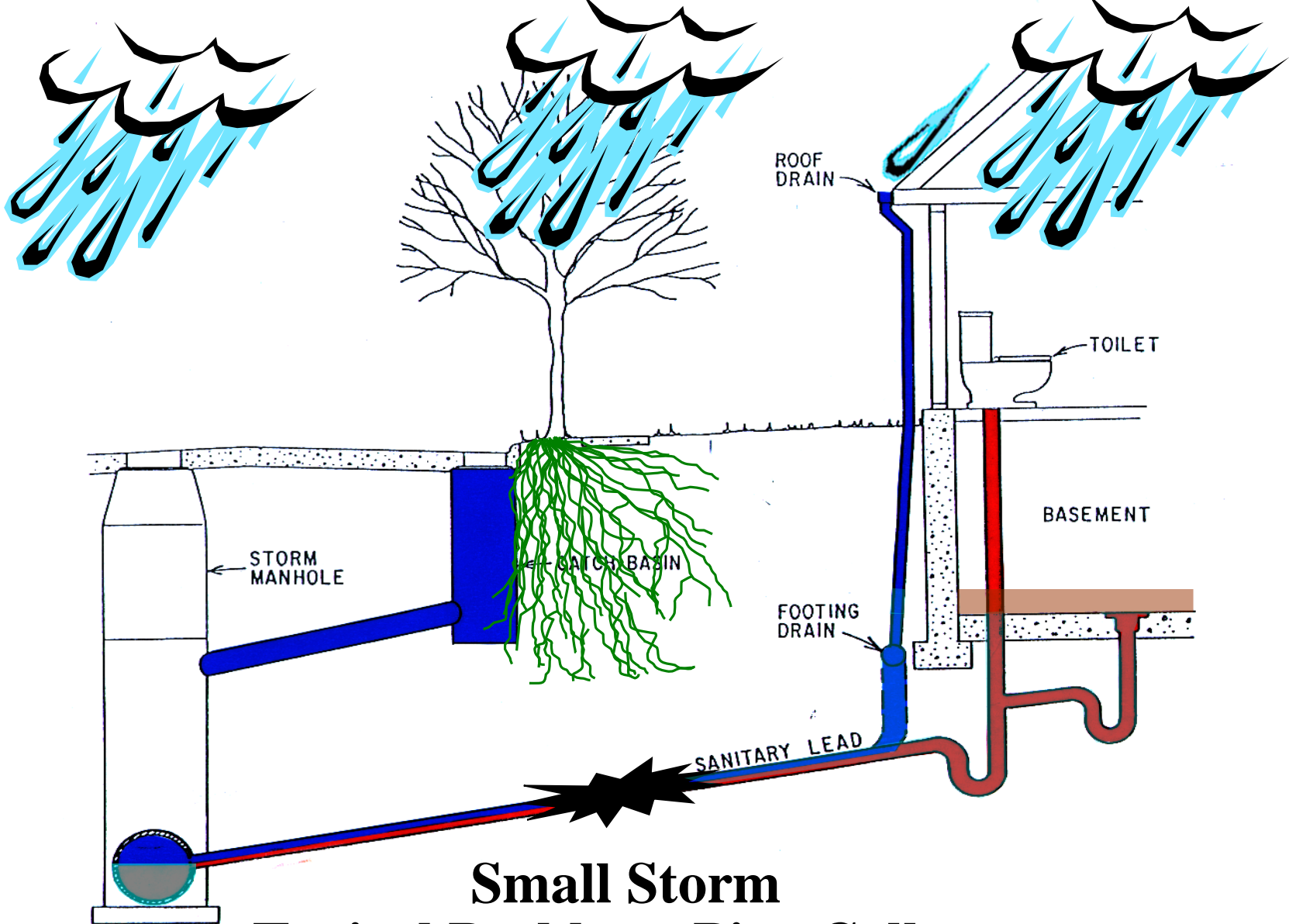

**Small Storm
Typical Problem: Pipe Collapse
Combined Sewer System**

Sewer Separation

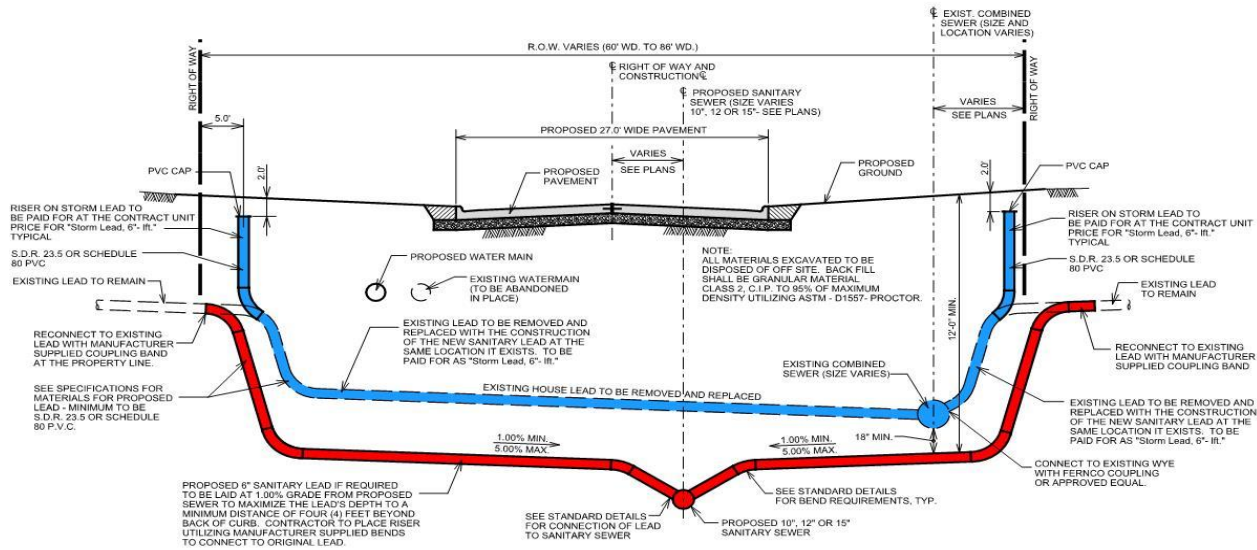

TYPICAL SANITARY BUILDING LEAD RECONNECTION DETAIL

NO SCALE

What to Expect

- Water service disruptions
- Driveway closures
- Access during construction
- Mail delivery
- Trash pickup
- School buses
- Landscaping in the right of way

Project Contacts

Project Engineer

Matt Slicker

Hubbell, Roth & Clark

248-454-6379

MSlicker@hrcengr.com

City of Southfield

Leigh Schultz, City Engineer

248-796-4810

Lschultz@cityofsouthfield.com