

DESIGN FILE = F:\13994\139924\1399226\addoc\1\1464301107.dgn
 USER NAME = kwe11ey
 FILE NAME: 54301.p15
 1 2 4 910 11 12 13 14 15 16 17 18 19 21 22 24 25 27 29 31
 GDLLE = **dpc\01\m607_rproj.m\NO_Sequenc
 CL.R. TEL: **srandor\smot\m607\NO_Sequenc
 50 51 52 53 54 55
 DATE: DATE: DATE:
 EXISTING BY:
 PROPOSED BY:
 LAST CORRECTION BY:

WB I-696 ENTRANCE RAMP FROM FRANKLIN ROAD
 CURVE NO.29
 CIRCULAR CURVE DATA
 $\Delta = 22^{\circ}25'35.2"$ Left
 R= 406.855
 T= 80.657
 L= 159.249
 E= 7.918
 PC= 12+309.690
 PI= 12+390.347
 PT= 12+468.939
 PC X=4087439.316, Y=110841.853
 PI X=4087514.440, Y=110871.23
 PT X=4087572.681, Y=110927.012
 PROPOSED SUPER= 6.0%

FRANKLIN POINT CURVE NO.4
 CIRCULAR CURVE DATA
 $\Delta = 19^{\circ}43'03.8"$ Left
 R= 45.337
 T= 7.879
 L= 15.602
 E= 0.680
 PC= 10+000.000
 PI= 10+007.801
 PT= 10+015.602
 PC X= 4087414.573, Y= 110894.154
 PI X= 4087421.768, Y= 110897.366
 PT X= 4087427.457, Y= 110902.816

SECTION 18
 TIN ,R10E
 CITY OF SOUTHFIELD

FRANKLIN POINT DRIVE
 BEGINNING= STA 10+016.055
 X=4087427.784, Y=110903.129

FRANKLIN POINT DRIVE
 END= STA 10+219.826
 X=4087574.924, Y=111044.100

WB I-696 ENTRANCE RAMP FROM FRANKLIN ROAD
 END= STA 12+551.561
 X=4087632.341, Y=110984.170

FINAL R.O.W.		
AUTH	DATE	NO. REVISION

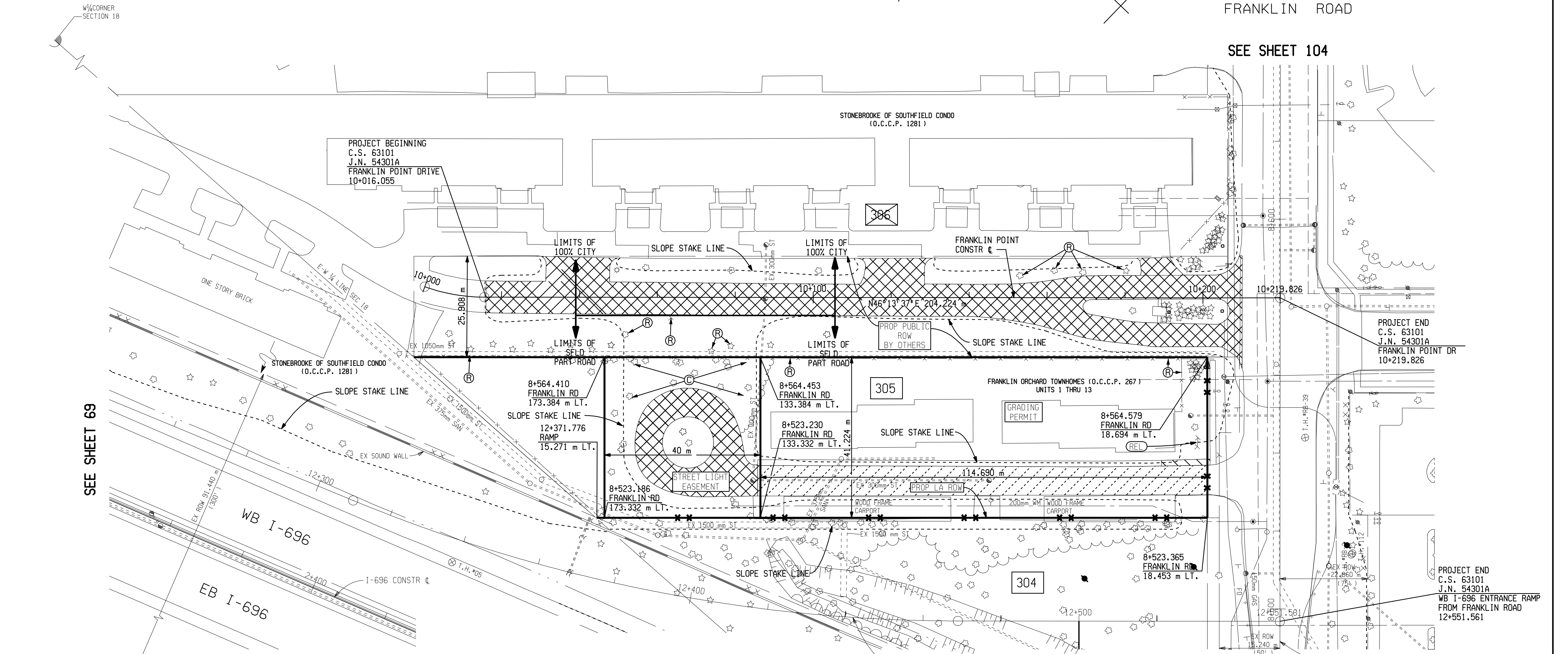

SEE SHEET 69

SEE SHEET 104

SEE SHEET 99

REMOVAL LEGEND

COLD MILLING BIT SURFACE	
REMOVING BITUMINOUS	
REMOVING SIDEWALK	
REMOVING PAVEMENT	
REMOVING CURB, GUTTER AND CURB & GUTTER	
REMOVING	(R)
ABANDONING	(A)
SAVE	(S)
BULKHEAD	(B)
CLEARING	(C)

	FRANKLIN ORCHARD (SFLD PART ROAD) JN 54301A	FRANKLIN POINT (100% CITY) JN 54301A	UNIT	QUANTITIES THIS SHEET
	840	7	m2	Clearing
	218		ea	Trees, Rem, 200 to 450 mm
		2680	m	Fence, Rem
	18		m2	Pavt, Rem
	865		m2	Sidewalk, Rem
			m2	Cold Milling Bit Surface

SECTION 18
 TIN ,R10E
 CITY OF SOUTHFIELD

FRANKLIN ROAD

REMOVAL SHEET

 Hubbell, Roth & Clark, Inc. CONSULTING ENGINEERS	 Michigan Department of Transportation	FRANKLIN POINT DRIVE: 10+016.055, TO 10+219.826 FRANKLIN ORCHARD TOWNHOMES DRIVE			
		DATE	SCALE	CONT. SEC.	JOB NO.
		11/01/05	1:500	63101	54301A
		DESIGN UNIT		SHEET NO.	
		sweeney		R.O.W 570	